

Connection and commissioning

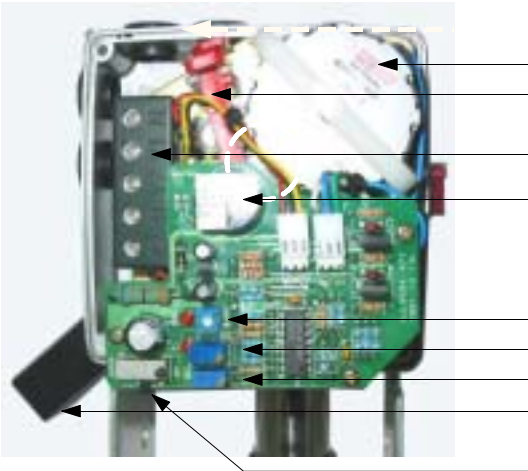

Connection terminal

Limit cam setter

Movement direction switch

Movement position and deadband adjustment volumes

Drive motor

Feed back potentiometer

Zero point adjustment volume ( )

Span adjustment volume

Manual lever

- Switch bank ( )

Position the switch-1 and adjust the close position

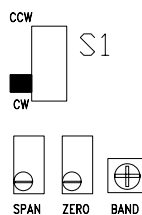
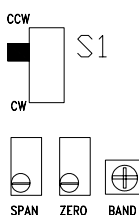
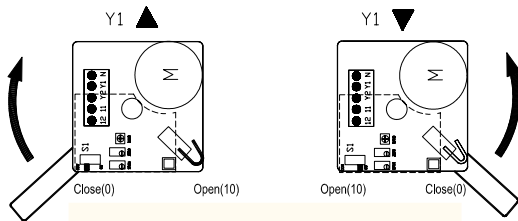

- Mounting advices

- Avoid from electrical shock
- Check the supply voltage 24Vac
- Check the transformer capacity
- Check the system Neutral(N) is common with the controller's Neutral(N) 가
- Check the movement direction

-Wiring diagram

- Disconnect the power of the controller and actuator power supply.
- Connect the control wire as following. 3

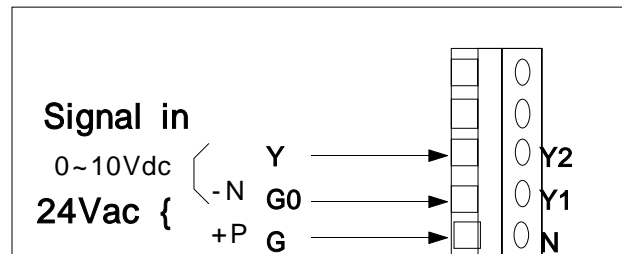

- Commissioning advice

- 가
- All factory settings should be kept as possible.

가  
If necessary to alter setting or mechanical arrangement, please read instruction manual step by step.

- Setting start(Zero) point  
( )

가  
(tooth)

가

가

가

Actuators must be calibrated the zero point after mounting on the valve or on the damper. Set the close point by limit cam and set the closed point. And adjust the zero point by turning the potentiometer.

When you locate the "auto/man" knob to "man" you can move the manual lever freely to left-ring or up-and according to the mounting position. When you put the knob back to "auto" the unit will go along automatically.

When the operating direction has to be altered change the switch-1 to opposite position. And check the rotating cam position at closed position then adjust potentiometer to meet the start(Zero) point.

Some times you will face at stuck of the manual lever due to the mismatch of the pinion teeth.

When you energize the power for a short time to move the pinion the Auto/Man knob can be easily positioned

- Manual positioning



/ auto/manual knob

Man

가

/ ( )

Auto

가

MAN

가

\* For more detail technical information please read data sheet