

Tender specification:

Oventrop return temperature limiter, body nickel plated, stem made of stainless steel, connection for threaded pipe or copper pipe.

Technical data:

Operating temperature t_s : 2 °C up to 100 °C

Max. operating pressure p_s : 10 bar

Max. differential pressure: 1 bar

Connection thread M 30 x 1.5

Thermostat "Uni RTLH"

may be limited and locked, with '0' setting,

permissible max. temperature: 100°C

Models:

Models:	Item no.:
white	102 71 65
chrome plated	102 71 72
Temperature range:	10-40 °C factory setting (return temperature) may be increased to 50 °C be recalibrating the limitation (40 °C)
anthracite:	114 90 68
Temperature range:	10-70 °C (return temperature)

Reversed angle pattern valve for the return pipe

DN 10 102 43 63

DN 15 102 43 64

Straight pattern valve for the return pipe

DN 10 102 44 63

DN 15 102 44 64

Application:

Return temperature limiters are, for instance, used to limit the return temperature of radiators or, in the lower temperature region, of combined radiator/underfloor heating systems with a small underfloor heating area. In surface heating systems, the return temperature has to be limited to a maximum of 40 °C (factory setting). Here, the thermostat is influenced by the heating medium, not the air temperature. Once the set temperature is exceeded, the valve closes and re-opens only when the temperature has dropped below the set value. The permissible max. flow temperature of the respective surface heating system has to be observed.

The operating fluid should be in accordance with the latest technical development (e.g. VDI 2035 – Avoidance of damage to hot water systems).

RTLH valve insert:

The Oventrop return temperature limiters are equipped with a valve insert with double disc. The maximum flow rate is reached at average piston position (approx. 1.5 = approx. one turn of the protection cap starting from the shut-off position).

If the thermostat "Uni RTLH" or the protection cap is removed, the double disc closes the valve to a low residual volume flow. This way, frost protection is guaranteed in surface heating systems and inadvertent overheating of the screed is avoided.

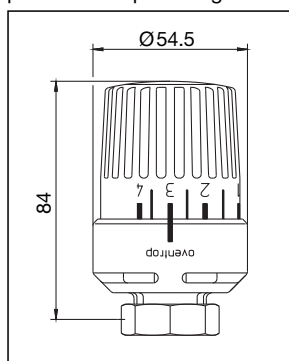

Thermostat "Uni RTLH"



Return temperature limiter

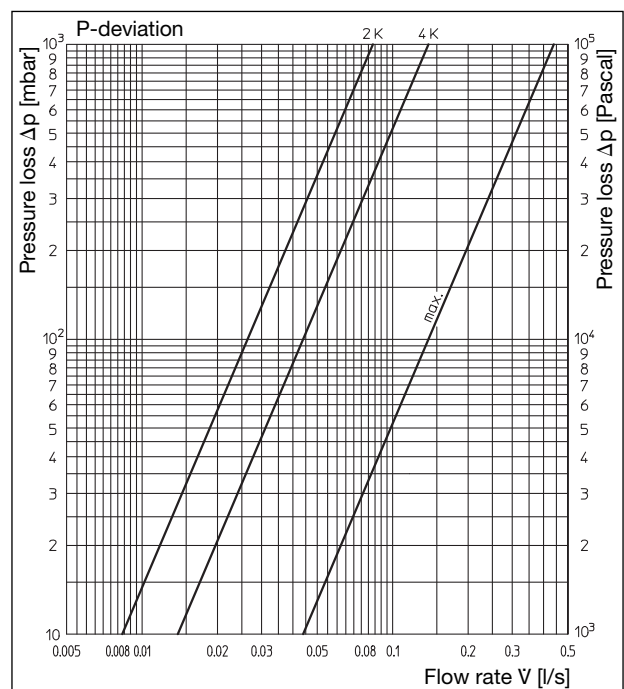

Performance data

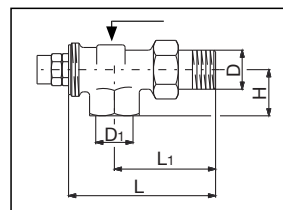

D	D ₁	H	L	L ₁
EN 10226-1	EN 10226-1	H	L	L ₁
R 3/8	Rp 3/8	23	74.5	52
R 1/2	Rp 1/2	26	82	58

Dimensions
reversed angle pattern valve

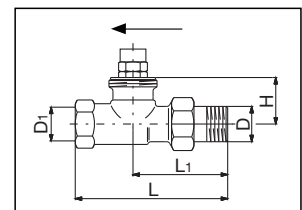

D	D ₁	H	L	L ₁
EN 10226-1	EN 10226-1	H	L	L ₁
R 3/8	Rp 3/8	28.5	85	59
R 1/2	Rp 1/2	28.5	95	59

Dimensions
straight pattern valve

Figures and symbols on the thermostat

Item no. 102 71 65/72: Item no. 114 90 68:

1 = about 10 °C	1 = about 10 °C
2 = about 20 °C	2 = about 20 °C
3 = about 30 °C	3 = about 30 °C
4 = about 40 °C	4 = about 40 °C
	5 = about 50 °C
	6 = about 60 °C
	7 = about 70 °C

The minor graduations between the figures represent a change of the return temperature of about 5°C

Limiting the control range:

The control range is limited at works to 40 °C (applies for item no. 102 71 65 and 102 71 72).

Other temperature values can be limited or locked as follows:

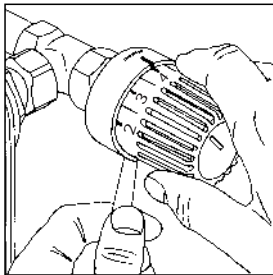

1. Remove the handgrip with the tool (item no. 198 91 00) or with a pin, e.g. with the push button of a pen. Insert the tool/pin in the hole provided on the lower side of the thermostat "Uni RTLH". By turning the handgrip to the shut-off position, it is easily removed. After having removed the handgrip, turn the knurled screw to the left, until the white calibration mark is in line with the indicator mark.

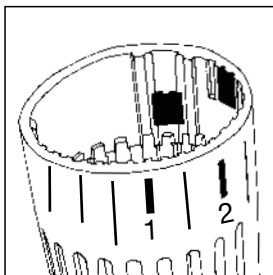

2. On the inner side of the handgrip you will find two clips in the "parking position". One of them limits the control range to position 4 (limitation to approx. 40 °C) as illustrated (applies for item no. 102 71 65 and 102 71 72).

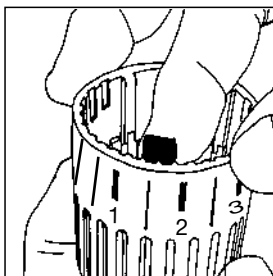

3. To limit the minimum control range, for instance at figure "2" (corresponds to about 20°C), one clip should be fitted into the groove immediately **before** figure "2" as illustrated (the groove directly opposite figure "2" thus remains free). Replace the handgrip so that figure "3" is in line with the indicator mark. Push down handgrip with hand to secure.

Cancellation of the limitation see at www.oventrop.de – Installation instructions for the specialised installer Thermostats "Uni LH" and "Uni LD"

Subject to technical modification without notice.

Product range 1
ti 52-1/10/MW
Edition 2014

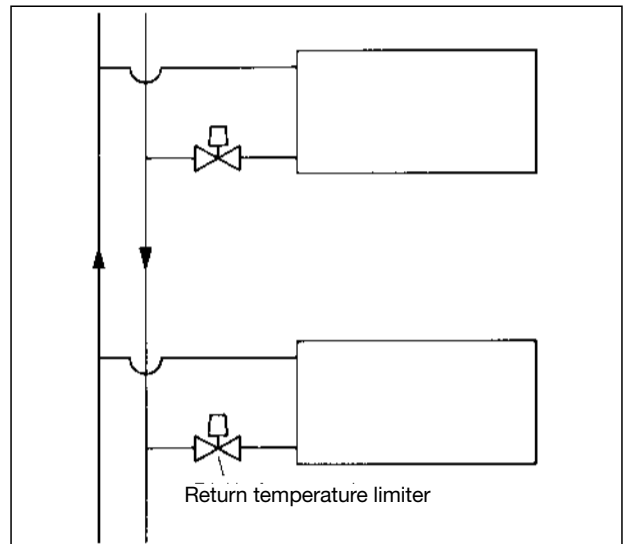

System illustration
Limitation of return temperature at radiators

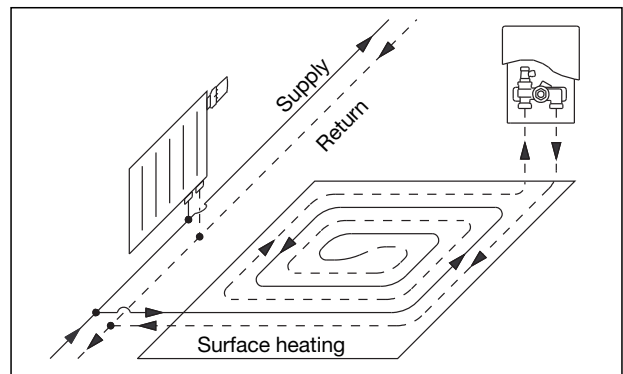

System illustration
Control in combined radiator/surface heating systems with "Unibox RTL"

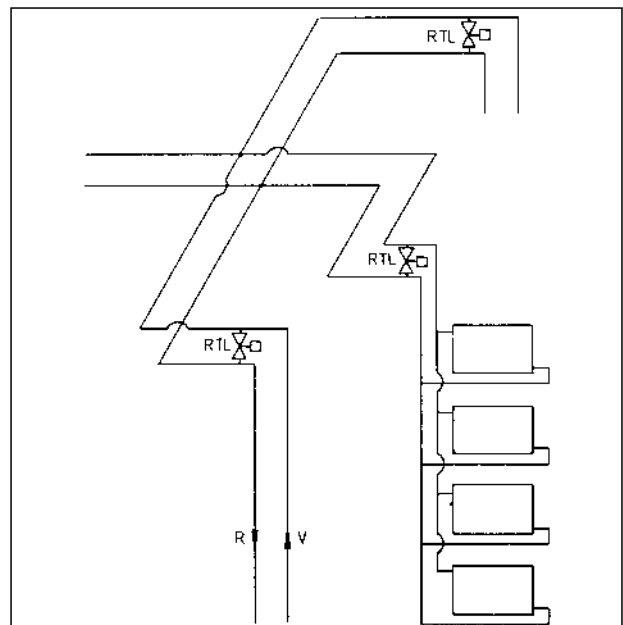

System illustration
Frost protection for upper distribution

OVENTROP GmbH & Co. KG Telephone +49(0) 2962 82-0
Paul-Oventrop-Straße 1 Fax +49(0) 2962 82-450
D-59939 Olsberg E-Mail mail@oventrop.de
Germany Internet www.oventrop.de

For an overview of our global presence visit www.oventrop.de