



GOLD RING Series 25, H5 Two-Way Pilot-Operated Valves

SPECIFICATIONS

Mechanical Characteristics

Standard Materials of Construction

- Body-Brass, 316 Stainless Steel as listed
- Seals-NBR
- Plunger and Pole Piece-430FR Stainless Steel
- Plunger Tube-305 Stainless Steel
- Springs-302 Stainless Steel
- Shading Coil-Copper (Brass Bodies), Silver (Stainless Steel Bodies)
- Disc Holder (Normally Open Valves)-Ryton
- Pilot Seats-Nickel Plated Brass
- Wire Screen-Brass or Stainless Steel

Compatible Fluids

- Gases, Fluid, Light Oils and other clean flowing media compatible with brass or stainless steel

Electrical Characteristics

Voltages

- DC-6, 12, 24, 120, 125 (other voltages available upon request)
- AC-24/60, 110/120-50/60, 220/240-50/60, 440/480-50/60

Coil

- Class F Standard, Class H Available

Agency Approvals

- Standard valves with general purpose or explosion proof solenoid enclosures are UL Listed and CSA Certified. For details, consult factory.

Miscellaneous

Temperature Ratings (media as listed)

- AC Voltages: 180°F max.
- DC Voltages: 180°F max.
- Ambient: 32-77°F (standard)
- For temperature variations, consult the factory.

Installation

- Valves should be mounted vertical and upright. See mounting dimensions (nominal) shown here. For certified dimensions, consult factory.

Applications

- Used in a variety of applications including: Automated Systems, Dispensing Systems, Instrumentation, Welding Equipment, Food Processing Machinery, Water Treatment Systems and Laundry Equipment.

PILOTED BRASS VALVES-NORMALLY CLOSED (ENERGIZE TO OPEN), NBR SEALS

AC VALVE SPECIFICATIONS

NPT Pipe Size	Orifice Diameter		Flow Factor		Operating Pressure Differential						Max. Temp.		AC Watt	Const. Ref.	Valve Part Number		
	inch	mm	Cv	Kv	Min. (PSI/Bar)	Max. (MOPD)			°F	°C							
						Air, Inert Gas (PSI/BAR)	Water (PSI/Bar)	Light Oil 300SSU (PSI/BAR)									
1/4	11/32	8.73	1.20	1.03	5	0.34	300	20.69	300	20.69	300	20.69	180	82	6.0	46	04F25C2122CAF
3/8	11/32	8.73	1.20	1.03	5	0.34	300	20.69	300	20.69	300	20.69	180	82	6.0	47	06F25C2122CAF
3/8	1/2	12.70	3.00	2.59	0	0.00	200	13.79	200	13.79	200	13.79	180	82	11.0	48	06FH5C2132ACF
3/8	1/2	12.70	3.00	2.59	1	0.07	300	20.69	235	16.21	235	16.21	180	82	11.0	48	06F25C2132ACF
1/2	1/2	12.70	3.60	3.10	0	0.00	200	13.79	200	13.79	200	13.79	180	82	11.0	48	08FH5C2132ACF
1/2	1/2	12.70	3.60	3.10	1	0.07	300	20.69	235	16.21	235	16.21	180	82	11.0	48	08F25C2132ACF
3/4	3/4	19.05	7.40	6.38	0	0.00	200	13.79	200	13.79	200	13.79	180	82	11.0	49	12FH5C2148ACF
3/4	3/4	19.05	7.40	6.38	1	0.07	300	20.69	235	16.21	235	16.21	180	82	11.0	49	12F25C2148ACF
1	1	25.40	12.2	10.52	1	0.07	300	20.69	300	20.69	300	20.69	180	82	11.0	50	16F25C2164ACF
1	1	25.40	12.2	10.52	0	0.00	150	10.34	125	8.62	125	8.62	174	79	16.0	50	16FH5C2164ADF

PILOTED BRASS VALVES-NORMALLY OPEN (ENERGIZE TO CLOSE), NBR SEALS

AC VALVE SPECIFICATIONS

NPT Pipe Size	Orifice Diameter		Flow Factor		Operating Pressure Differential						Max. Temp.		AC Watt	Const. Ref.	Valve Part Number		
	inch	mm	Cv	Kv	Min. (PSI/Bar)	Max. (MOPD)			°F	°C							
						Air, Inert Gas (PSI/BAR)	Water (PSI/Bar)	Light Oil 300SSU (PSI/BAR)									
1/4	11/32	8.73	1.20	1.03	5	0.34	300	20.69	300	20.69	300	20.69	180	82	11.0	51	04F25O2122CCF
3/8	11/32	8.73	1.20	1.03	5	0.34	300	20.69	300	20.69	300	20.69	180	82	11.0	52	06F25O2122CCF
3/8	1/2	12.70	3.0	2.59	1	0.07	200	13.79	175	12.07	175	12.07	180	82	11.0	53	06F25O2132ACF
1/2	1/2	12.70	3.60	3.10	1	0.07	200	13.79	175	12.07	175	12.07	180	82	11.0	53	08F25O2132ACF
3/4	3/4	19.05	7.40	6.38	1	0.07	275	18.97	275	18.97	275	18.97	180	82	11.0	54	12F25O2148ACF
1	1	25.40	12.2	10.52	1	0.07	300	20.69	250	17.24	230	15.86	180	82	11.0	55	16F25O2164ACF

To choose a solenoid for your valve, refer to the AC or DC chart found on the flap attached to the back cover of this catalog.

Series 25 H5 Two-Way Pilot-Operated Valves

PILOTED BRASS VALVES– NORMALLY CLOSED (ENERGIZE TO OPEN), NBR SEALS

DC VALVE SPECIFICATIONS

NPT Pipe Size	Orifice Diameter		Flow Factor		Operating Pressure Differential								Max. Temp.		AC Watt	Const. Ref.	Valve Part Number
	inch	mm	Cv	Kv	Min. (PSI/Bar)	Max. (MOPD)						°F	°C				
						Air, Inert Gas (PSI/BAR)		Water (PSI/Bar)		Light Oil 300SSU (PSI/BAR)							
1/4	11/32	8.73	1.20	1.03	5	0.34	300	20.69	300	20.69	300	20.69	180	82	11.0	51	04F25O2122CCF
1/4	11/32	8.73	1.20	1.03	5	0.34	275	18.97	275	18.97	275	18.97	150	66	11.5	56	04F25C2122C3F
3/8	11/32	8.73	1.20	1.03	5	0.34	275	18.97	275	18.97	275	18.97	150	66	11.5	57	06F25C2122C3F
3/8	1/2	12.70	3.00	2.59	1	0.07	130	8.97	130	8.97	130	8.97	180	82	11.5	48	06F25C2132A3F
1/2	1/2	12.70	3.60	3.10	1	0.07	130	8.97	130	8.97	130	8.97	180	82	11.5	48	08F25C2132A3F
3/4	3/4	19.05	7.40	6.38	1	0.07	70	4.83	70	4.83	70	4.83	150	66	11.5	49	12F25C2148A3F
1	1	25.40	12.20	10.52	1	0.07	275	18.97	275	18.97	275	18.97	180	82	11.5	50	16F25C2164A3F

PILOTED BRASS VALVES– NORMALLY OPEN (ENERGIZE TO CLOSE), NBR SEALS

DC VALVE SPECIFICATIONS

NPT Pipe Size	Orifice Diameter		Flow Factor		Operating Pressure Differential								Max. Temp.		AC Watt	Const. Ref.	Valve Part Number
	inch	mm	Cv	Kv	Min. (PSI/Bar)	Max. (MOPD)						°F	°C				
						Air, Inert Gas (PSI/BAR)		Water (PSI/Bar)		Light Oil 300SSU (PSI/BAR)							
1/4	11/32	8.73	1.20	1.03	5	0.34	160	11.03	160	11.03	160	11.03	150	66	11.5	51	04F25O2122C3F
3/8	1/2	12.70	3.00	2.59	1	0.07	200	13.79	175	12.07	175	12.07	180	82	11.5	53	06F25O2122A3F
3/8	1/2	12.70	3.00	2.59	1	0.07	200	13.79	175	12.07	175	12.07	180	82	11.5	53	06F25O2132A3F
1/2	1/2	12.70	3.60	3.10	1	0.07	200	13.79	175	12.07	175	12.07	180	82	11.5	53	08F25O2132A3F
3/4	3/4	19.05	7.40	6.38	1	0.07	230	15.86	200	13.79	200	13.79	150	66	11.5	54	12F25O2148A3F
1	1	25.40	12.20	10.52	1	0.07	200	13.79	150	10.34	125	8.62	180	82	11.5	55	16F25O2164A3F

PILOTED STAINLESS STEEL VALVES– NORMALLY CLOSED (ENERGIZE TO OPEN), NBR SEALS

AC VALVE SPECIFICATIONS

NPT Pipe Size	Orifice Diameter		Flow Factor		Operating Pressure Differential								Max. Temp.		AC Watt	Const. Ref.	Valve Part Number
	inch	mm	Cv	Kv	Min. (PSI/Bar)	Max. (MOPD)						°F	°C				
						Air, Inert Gas (PSI/BAR)		Water (PSI/Bar)		Light Oil 300SSU (PSI/BAR)							
1/4	11/32	8.73	1.20	1.03	5	0.34	300	20.69	300	20.69	300	20.69	180	82	6.0	46A	04F25C6122CAF
3/8	11/32	8.73	1.20	1.03	5	0.34	300	20.69	300	20.69	300	20.69	180	82	6.0	47A	06F25C6122CAF

PILOTED STAINLESS STEEL VALVES– NORMALLY OPEN (ENERGIZE TO CLOSE), NBR SEALS

AC VALVE SPECIFICATIONS

NPT Pipe Size	Orifice Diameter		Flow Factor		Operating Pressure Differential								Max. Temp.		AC Watt	Const. Ref.	Valve Part Number
	inch	mm	Cv	Kv	Min. (PSI/Bar)	Max. (MOPD)						°F	°C				
						Air, Inert Gas (PSI/BAR)		Water (PSI/Bar)		Light Oil 300SSU (PSI/BAR)							
1/4	11/32	8.73	1.20	1.03	5	0.34	300	20.69	300	20.69	300	20.69	180	82	11.0	51A	04F25O6122CCF
3/8	11/32	8.73	1.20	1.03	5	0.34	300	20.69	300	20.69	300	20.69	180	82	11.0	52A	06F25O6122CCF

DRAWINGS

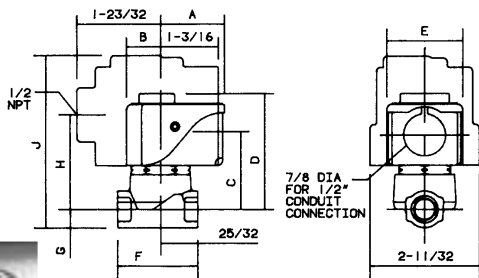

#46, 46A, 47, 47A,
51, 51A, 52, 52A, 56, 57

	46	46A	47	47A	51	51A	52	52A	56	57
A	1 5/16	1 5/16	1 5/16	1 5/16	1 17/32	1 17/32	1 17/32	1 17/32	1 17/32	1 17/32
B	23/32	23/32	23/32	23/32	7/8	7/8	7/8	7/8	7/8	7/8
C	1 9/16	1 17/32	1 5/8	1 5/8	1 25/32	1 3/4	1 27/32	1 27/32	1 15/16	2
D	2 7/16	2 13/32	2 1/2	2 1/2	2 7/8	2 27/32	2 15/16	2 15/16	2 7/8	2 15/16
E	1 9/16	1 9/16	1 9/16	1 9/16	1 13/16	1 13/16	1 13/16	1 13/16	1 13/16	1 13/16
F	1 3/4	1 7/8	1 3/4	1 7/8	1 3/4	1 7/8	1 3/4	1 7/8	1 3/4	1 3/4
G	3/8	9/16	7/16	9/16	3/8	9/16	7/16	9/16	3/8	7/16
H	1 31/32	1 15/16	2 1/32	2 1/32	1 31/32	1 15/16	2 1/32	2 1/32	1 31/32	2 1/32
J	3 9/16	3 17/32	3 5/8	3 5/8	3 9/16	3 17/32	3 5/8	3 5/8	3 9/16	3 5/8
K	1 3/16	1	13/16	1	13/16	1	13/16	1	13/16	13/16

Explosion-Proof/Watertight Shown in Outline

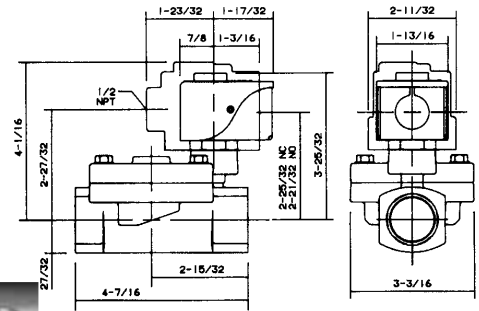

#50, 55

	Drawing 48	Drawing 49	Drawing 53	Drawing 54
A	3 5/8	3 21/32	3 5/8	3 21/32
B	1/2	5/8	1/2	5/8
C	1 5/16	1 5/8	1 5/16	1 5/8
D	1 1/8	1 1/2	1 1/8	1 1/2
E	2 7/16	3 1/8	2 7/16	3 1/8
F	2 5/16	2 11/32	2 7/32	2 1/4
G	3 5/16	3 15/32	3 5/16	3 15/32
H	2 1/4	3 1/2	2 1/4	2 29/32

Explosion-Proof/Watertight
Shown in Outline

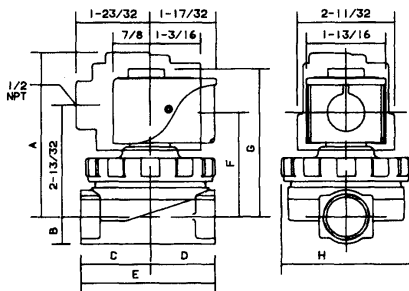

#48, 49, 53, 54

To choose a solenoid for your valve, refer to the AC or DC chart found on the flap attached to the back cover of this catalog.