

**IN STOCK AT
JOHNSON VALVES
TEL 023 80 669666**

542 STANDARD LIFT

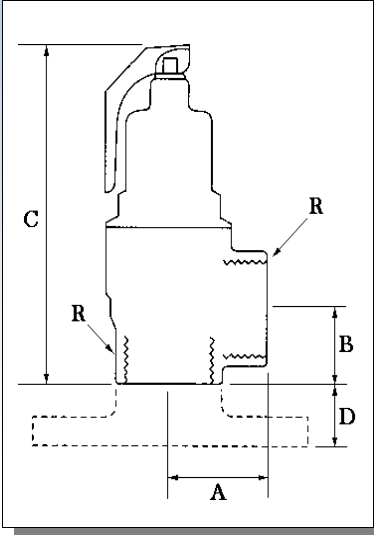

NABIC

FIG 542-EASING LEVER

The fig 542 safety valve is an extremely versatile valve, suitable for use on hot water, steam or air. Although designed primarily for protection of hot water boilers, it's wide range of applications make it an ideal general purpose safety valve.

The fig 542 is of gunmetal construction, with diaphragm protected working parts and P.T.F.E. to metal seating. All wetted parts are manufactured from dezincification resistant materials, approved by the Water Research Centre for use on potable water.

Inlet and outlet connections are of equal size, with female threads to BS 21. Sizes, from DN32 upwards, are also available with flanged inlet.

ALSO AVAILABLE

Fig 542L

The fig 542L range are intended for use where pressure tightness is required on the discharge side of the valve. They are ideal for pump relief, bypass relief, outside installations an inflammable fluids.

The valves are of a gunmetal construction with top guided copper alloy parts, chrome vanadium spring and PTFE to metal seating. O-ring seals ensure pressure tightness at cover and cap joints.



Fig 542

SIZE	R	A	B	C	D
DN15	1/2	30	23	113	-
DN20	3/4	34	23	118	-
DN25	1	39	27	132	-
DN32	1 1/4	46	33	153	27
DN40	1 1/2	54	38	198	27
DN50	2	64	46	236	27
DN65	2 1/2	76	55	275	28
DN80	3	90	65	335	31

Features and Benefits.

- AOTC APPROVED TO BS6759.
- Resilient PTFE seating design.
- Diaphragm protected working parts.
- Approved by Water Research Centre.
- UKWFBS listed.
- Padlock available.

Technical Data.

Pressure range:-
0.3 to 10.5 bar.
Temperature Range:-
Up to 190°C.

When ordering, the following information is necessary to ensure that the correct size and type of valve is selected.

1. Service.
2. Application.
3. System working pressure.
4. Set pressure.
5. Maximum Capacity
6. Inlet connection.

**CAN BE SET & CERTIFICATED TO YOUR EXACT PRESSURE IN MINUTES
NABIC AUTHORISED DISTRIBUTOR**